

**MOD : WR-AC120-09**

**Production code : XDAP 120**



**WR-AC30-07 | WR-AC60-08 | WR-AC120-09**

Plate Warmer



Instruction Manual



Manuel d'Instructions



Handleiding

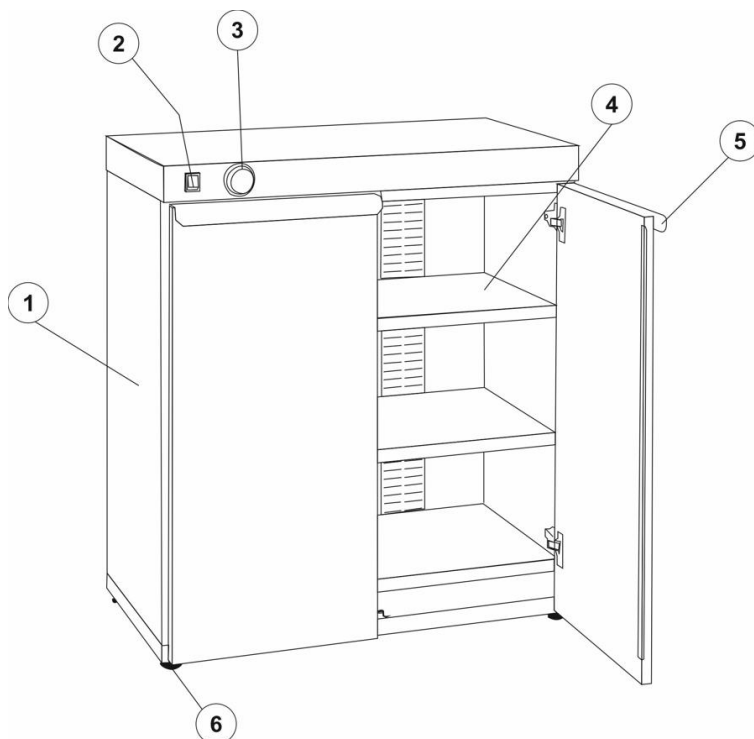

1. Chassis/Structure.
2. Main switch with a green light pilot
3. Temperature regulation thermostat
4. Shelf
5. Door with a cool touch handle
6. Adjustable and non-slip feet

# Spare Parts

WR-AC30-07  
WR-AC60-08

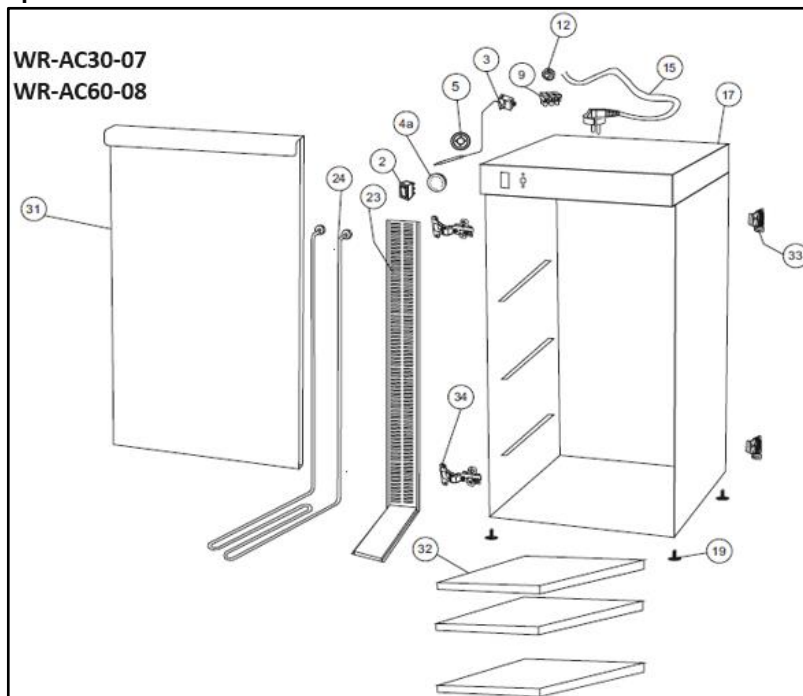

Fig. 1

WR-AC120-09

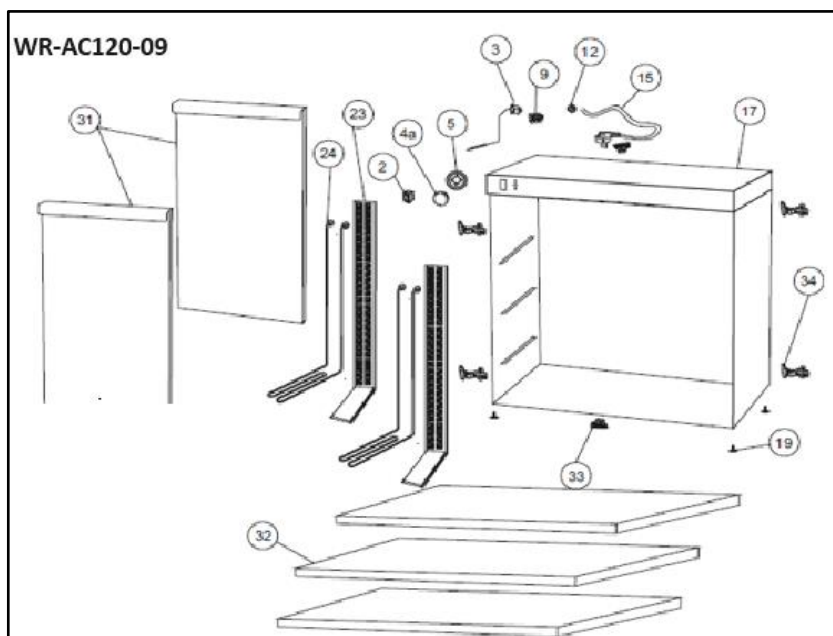

Fig. 2

**REMARK!**

Whenever you need to order a component, you must provide:

- ✓ Model
- ✓ Serial Nr.
- ✓ Spare Part nr.







MOD.			Cap. (Nr.  )	Nr of 	Nr.  / 	 KG
WR-AC30-07	400W	230V~50/60Hz	30	2	15	16,2
WR-AC60-08	750W	230V~50/60Hz	60	3	20	22
WR-AC120-09	1500W	230V~50/60Hz	120	3	40	41

Table 1

We reserve the right to change specifications without prior notice for the purpose of product development and improvement.

Electric Schemes

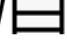
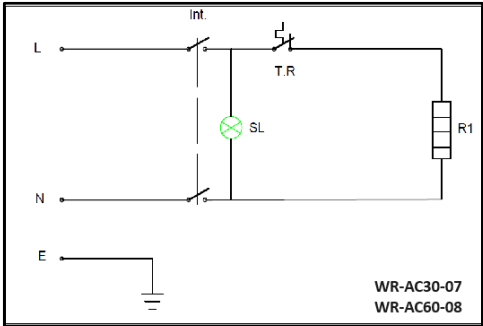

Fig. 3

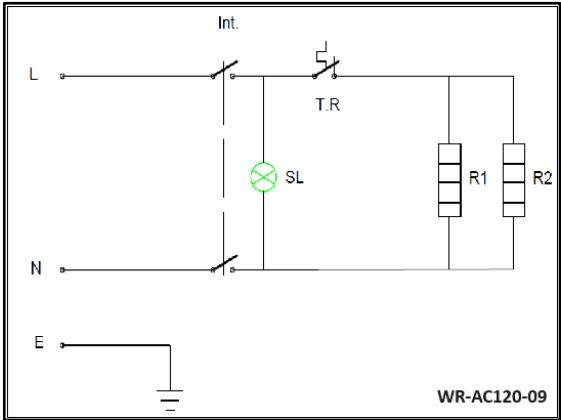

Fig. 4

**TR:**  
Regulating thermostat

**SL:**  
Pilot Light

**R1; R2:**  
Heating Element

**INT:**  
Main switch

Packing Contents

WR-AC30-07

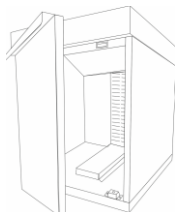

Fig 5

WR-AC60-08

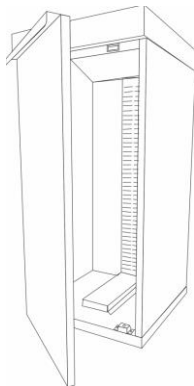

Fig.6

WR-AC120-09

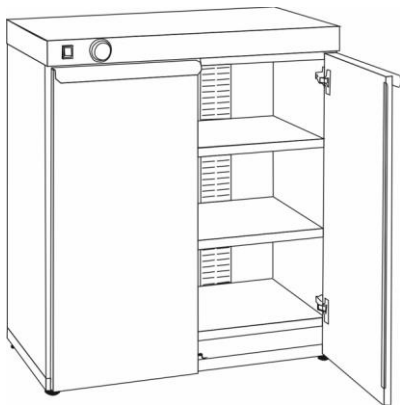
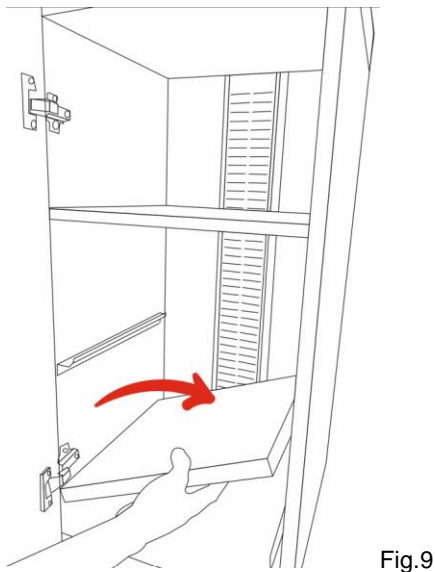
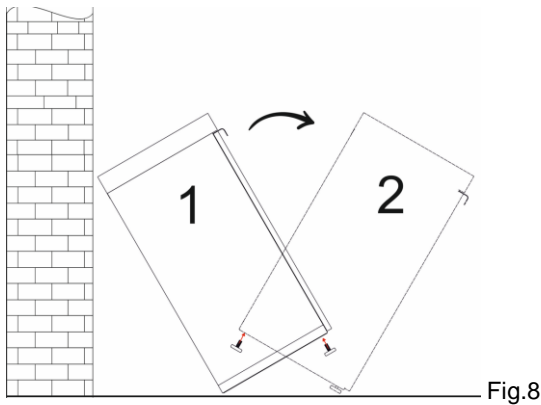

Fig.7





## TABLE OF CONTENTS

### **1. INTRODUCTION**

#### 1.1. Symbols & Marks

### **2. GENERAL SAFETY INSTRUCTIONS**

#### 2.1. General principles

#### 2.2. Work environment

#### 2.3. Electrical safety

#### 2.4. Cleaning

#### 2.5. Service and Maintenance

### **3. SPECIFIC SATETY INSTRUCTIONS**

#### 3.1. Transporting risk

#### 3.2. Burns Hazard

#### 3.3. Fire or explosion risk

#### 3.4. Purpose of use

### **4. INSTALLATION AND USE**

#### 4.1. Appliance installation

#### 4.2. Operating instructions

#### 4.3. Warming instructions

#### 4.4. After use

### **5. CLEANING**

### **6. MAINTENANCE AND ANOMALIES**

### **7. WARRANTY AND LIABILITY**

### **8. RECYCLING**

# 1. INTRODUCTION



Read these instructions carefully before using this product for the first time, even if you feel that you are familiar with this type of appliances.

Keep the instruction manual in a safety place for future reference, and in the case of passing on or selling the product to third parties, these instructions must be delivered together with it.

For your convenience, register the model and serial number (located on the product identification plate). These 2 numbers should always be displayed when you have questions about the product or need assistance/maintenance.

Make sure that the safety instructions written in this manual are strictly followed to avoid personal and/or property damage.

This product has been manufactured by qualified people, using high quality materials and in accordance with EU regulations, ensuring that you are purchasing a safe and efficient product!!!

## 1.1. Symbols & Marks

In this manual, and on labels placed on the product, symbols are used to highlight important safety instructions and any advice relating to the device. The instructions must be followed very carefully to avoid any risk of accident, personal injury or property damage.



**DANGER!** This symbol highlights hazards which could lead to death.



**WARNING!** This symbol highlight risks that are likely to cause injury or could result in death.



**CAUTION!** This symbol highlights a potentially hazardous situation that must be avoided. Failure to do so may result in minor to moderate injury.



**HOT SURFACE!** This symbol communicates the presence of hot surfaces alerting individuals to exercise caution and avoid direct contact.



**HAZARDOUS ELECTRICAL VOLTAGE!** This symbol warns others of the dangers from electrical shock risks. Shocks from equipment can cause severe and permanent injuries.



**REMARK!** This symbol highlights important recommendations and information for the effective use of the device and minimizing potential failures.



**Product Recycling.** For disposal of the appliance, consider and act in accordance with national and local rules and regulations.



**Restriction of Hazardous Substances.** In the manufacture of this product, the guidelines of the directive RoHs have been followed.



## **2. GENERAL SAFETY INSTRUCTIONS**

Safe operation of the appliance depends on appropriate and thorough use. Negligent handling of the appliance can lead to danger to life and limb of the user and/or third parties as well as hazards to the appliance itself and the other operator's property.

When using any electrically powered product, safety precautions should always be followed, including the following:

### **2.1. General principles**

- Before using the equipment, check whether there is any visible damage on the outside. Never use a damaged device.
- Your device is protected with a plastic film surrounding its structure. Make sure that you remove it before start operating the appliance.
- Ensure that children do not have access to play with this device. Do not leave the appliance unattended, especially near children.
- Children under 14 years and people with impaired physical, sensory or mental capacities, or people without relevant experience or knowledge, should not use this appliance, unless they benefit from adequate supervision or have received prior instruction on the safe use of the appliance and they understand the risks involved.
- Handling, cleaning and user's maintenance should not be carried out by children unless older than 14 and supervised.
- Safe operation is only guaranteed when using the appliance for its intended purpose.
- Any use beyond its intended purpose and/or any other use of the device is prohibited and is not considered conventional. The manufacturer cannot be held responsible for inappropriate or incorrect use. The user is responsible for all damages resulting from inappropriate use.
- When passing on/selling the device to third parties, this manual must be delivered together with the device.

### **2.2. Work environment**

- The device must only be used in environments protected from the external environment.
- The device must not be placed in places close to combustible materials or materials that are susceptible to deformation with heat. If this is not possible, the area must be covered with a material that is a good thermal insulator and non-combustible. Provide a location with as little humidity as possible.
- Do not place the device near water faucets.
- Do not place the device too close to an electrical outlet.

### 2.3. Electrical safety



#### **DANGER!** Electric shock hazard!

- Only connect the device to a socket or installation suitable for the electrical parameters indicated on the device's specification plate. Make sure that the device is connected to an electrical circuit sized for the power indicated on the rating plate.
- Connect the device to an electrical circuit with an earth connection. The electrical safety of the device is only guaranteed if it has a correct earth connection.
- Do not connect the device to the power supply with a multiple plug or extension cable. These do not guarantee the safety of the equipment.
- Do not use this appliance with a chronometer control device or any other device that operates it automatically.
- Check the power cord regularly for damage. Do not use it if the cable or plug are damaged or if you notice that the appliance does not work correctly.
- Do not operate the appliance with the cable tangled, folded or bent. It must always remain fully unrolled. Never place the device or other objects on the power cable.
- Do not lay the power cable over inflammable materials. Do not cover the cable. Keep away the cable from operating range and do not immerse it into water.
- Do not turn off the device by pulling on the cord. The power cord must be disconnected from the socket only by pulling the plug.
- When inserting and removing the plug from the wall socket, the main switch and the regulatory thermostat must be OFF, "0" position.
- The cable must not touch any hot parts or sharp edges. The power cable should not hang over the side of the working surface. Ensure that no one can step on, or trip over the cable.
- Never carry or lift the device by the power cord.
- Make sure that no water or liquids are in contact with the electrical components.
- Do not use the device with wet/moist hands, or standing on wet surface.
- Always disconnect the device from the electric power supply:
  - ❖ when the device is not used;
  - ❖ in case of anomalies during operation;
  - ❖ before cleaning.

### 2.4. Cleaning

- Before cleaning, **ENSURE** that the appliance is unplugged from the electrical power supply and wait it is **cold down**.
- **NEVER** use jets of water for cleaning to avoid the contact of the electrical parts with the water.
- **NEVER** use abrasive products, solvents or acids for cleaning the product.

### 2.5. Service and Maintenance

- Installation and repair interventions must strictly comply with current national and local safety regulations.
- Any technical interventions as well as assembly and maintenance must only be carried out by qualified customer service. The manufacturer is not responsible for damages resulting from repairs and other interventions carried out by unqualified people. Use only spare parts of origin.

### 3. SPECIFIC SAFETY INSTRUCTIONS

#### 3.1. Transporting Risks



##### **CAUTION!**

- Do not move the appliance while it is under operation. Disconnect the appliance from power supply when moving and hold it at the bottom.
- Special care must be taken when moving or transporting products weighing more than 25 Kg (Heavy product). See the product weight in Table 1 and if you have a "heavy product", move it with at least 2 people or using a cart.
- **NEVER** move the product with dishes on the shelves.

#### 3.2. Burns Hazard



##### **HOT SURFACE!**

When the Plate Warmer is operating, the temperature of the accessible surfaces are extremely high

- During the operation there is a risk of burning hands and arms, so **DO NOT** touch the hot external surface when the Warm Plate is in operation.
- Always use heat resistance gloves to take out the warm plates.

#### 3.3. Fire or explosion risk



##### **WARNING!**

- Never operate the device near combustible, easily flammable materials (e.g.: petrol, spirit, alcohol etc.). They evaporate through heating and in case of contact with ignition sources deflagrations can occur which can lead to serious personal injuries and property damages.
- When a fire arises disconnect it from the power supply before you initiate appropriate measures for fire-fighting. Provide sufficient supply of fresh air.



##### **CAUTION!**

- Never extinguish the fire with water when the power plug is connected to the socket. Electric shock hazard!

#### 3.4. Purpose of use



##### **CAUTION!**

This appliance has been developed for warming plates and maintain them warm to the set temperature. Any other use may lead to damage of the appliance or personal injury.

For service catering, these appliances are intended to be used by qualified/trained persons and in places such as:

- ✓ kitchens of hotels and restaurants;
- ✓ canteens, schools and hospitals;
- ✓ catered events;

Operating the appliance for any other purpose shall be deemed a misuse of the device. The user shall be solely liable for improper use of the device.

## 4. ASSEMBLY, INSTALLATION AND USE

### 4.1. Assembly and Installation



#### **CAUTION!**

The assembly or disassembly operations are performed with the appliance disconnected from the power supply!!!

- Unpack the device and make sure that the protection plastic film surrounding the structure is totally removed. Remove it slowly ensuring that no glue residues will stay in the appliance. Remove the film also from the shelves. Discard the entire packaging material according to the regulations valid in the country where the appliance is being installed.
- Place the 4 feet (No.6) on the base of the product as shown in Fig. 8
- Place the shelves inside the cabinet, on the top of the side supports (Models WR-AC30-07 | WR-AC60-08) as shown in Fig. 9. Note: The model WR-AC120-09 is delivered with the shelves already in place.
- The installation, connection and maintenance services of the device must be performed by a qualified and certified technician.
- Choose a dry location where the equipment cannot come into direct contact with water.
- Place the equipment on a clean, stable and level surface.
- Keep the device away from flammable or heat-deformable materials. If this is not possible, ensure insulation with a non-flammable, heat-resistant insulation material. Keep a distance of at least 20 cm at the sides and at the rear from walls and other objects. Take into account the applicable fire protection regulations.
- Ensure that all shelves are firmly in place.
- NOT overload the interior shelves. See recommended MAX load in Tab1.



#### **REMARK**

Due to manufacturing residues, the appliance may emit a light odour during the first few uses. This is normal and does not indicate any defect or hazard. Make sure the appliance is well ventilated.



#### **DANGER! Hazardous Electrical Voltage!**

The electrical voltage may be considerably dangerous to limb and life of persons to lead to injuries.

#### **Electrical installation:**

- Check the specifications indicated on the equipment's rating plate and ensure connection to an electrical installation correctly sized for the device and with an earth connection. Otherwise, do not put the appliance into operation.
- Make sure that the access to the plug is easy to quickly the appliance if the need arises.

- Do not use any extension leads in wet areas.

## 4.2. Operating Instructions

The Warmer Plate should be thoroughly clean before putting it into operation for the first time.

- Before connecting the appliance to the power supply:
  - ✓ Clean the interior of the product in accordance with the instruction of the section 5. "CLEANING".
  - ✓ Make sure that the main switch (No.2) and the temperature regulating knob (No.3) are in the position "OFF"/"0".
- Connect the power cable plug in a wall socket (see electrical specifications).
- Place the plates on the shelves, never exceeding the MAX loading capacity/shelf (Table 1).
- Switch on the product by pressing the main switch (No. 2) to the position OFF (green pilot on switch must lit).

## 4.3. Warming Instructions

- Turn the thermostat knob (No.3) clockwise to 90°C (1<sup>st</sup> cycle) for faster air heating. After the 1<sup>st</sup> heating cycle, turn the thermostat knob clockwise and counter clockwise to the desired temperature. This procedure will be repeated automatically as the thermostat maintains the air at the selected temperature.
- You can now remove the heated dishes from the shelves and place the food on them. This helps maintain the temperature of the food, preserving all the flavours, until serving time.

### Attention:

- ✓ Never place plastic containers within the unit.
- ✓ Switch OFF the appliance by pressing the main switch before taking out the plate (green pilot light on switch is not lit);
- ✓ Plates are warm, use a heat resistance glove if needed (not supplied).



### REMARK

- Due to manufacturing residues, the appliance may emit a light odour during the first few uses. This is normal and does not indicate any defect or hazard. Make sure the appliance is well ventilated.
- During operation, it is recommended to keep the doors closed to avoid the loss of hot air and consequently save heating costs.

## 4.4. After use

**ALWAYS** disconnect the product from the power source, removing the power cord plug from the wall socket, when it is no longer in use.

- After the appliance is off, wait that itself and the water cool down completely before move or cleaning it.
- Clean appliance in accordance with the cleaning instructions (Section 5).

### Attention:

Device failures due to the lack of cleaning are not covered by the warranty. If the instructions set forth in this manual are not followed, the warranty claims will be rejected

- If the appliance is not kept in a good state of cleanliness, this can adversely affect the life of the product and result in a dangerous situation.
- If the appliance is not cleaned properly, it will reduce its lifespan and may result in a dangerous condition during use.



## 5. CLEANING

**Ensure that the Safety Instructions described in 2.2 are followed.**

- With a cloth or sponge slightly dampened with a mild soap, clean:
  - ✓ the inside of the cabinet and the shelves;
  - ✓ the exterior of the chassis/structure;
- Dry well with a soft cloth before reconnecting it.

## 6. MAINTENANCE AND ANOMALIES

Carry out a periodic check of the equipment to ensure greater durability of the components. This must be done by a qualified technician.

Any repair carried out by people other than authorized technicians will result in the cancellation of the warranty.

- In the event of an electrical or other fault, do not attempt to repair it, take the device to an authorized Technical Assistance Service.
- If the power cord is damaged, it must be replaced by the manufacturer, authorized agents or personnel qualified for this task, in order to avoid dangerous situations.
- Cable characteristics:  
H05RN-F 3G1.5mm2 provided with a Schuko plug rated 16Amp.

### Possible faults and solutions:

Failure	Possible Causes	Action to take
The appliance won't turn on.	Power cord is not plugged into a live electrical outlet; Circuit breaker tripped;	Plug in the power cord;  Check the circuit breaker on the electrical supply board.
	The main switch is not in the position "ON" (green pilot light on switch is not lit);	Check if main switch is in the position "I" (the green pilot on switch must lit)  If none of the above actions solve the failure, contact your dealer or a technician.
	The main switch is defective (green pilot light on switch is not lit);	Contact a technician to replace the parts.
The product does not heat up	Appliance is not ON;	Check if the appliance is turned ON;  If the above action doesn't solve the failure contact your dealer or a technician.
The requested temperature is not reached.	The temperature regulating thermostat is defective; The resistance is defective.	Contact a technician to replace the parts..

## 7. WARRANTY AND LIABILITY

The warranty is valid for 1 year from the date of purchase and covers defects of origin, whether material or manufacturing.

The warranty is limited to the replacement of faulty parts or products and excludes any consequential loss or expense incurred by the buyer.

Manufacturer is not liable for any damages or faults caused by:

- defects which arise from faulty installation, inadequate maintenance, incorrect use or fair wear and tear are not covered by the guarantee;
- violation of advice concerning operation and cleaning;
- use other than designed;
- alterations made by user;
- use of inadequate spare parts;

## 8. RECYCLING



**■ Treatment of packaging material:** Before using the device for the first time, remove the protective plastic from the stainless-steel structure. Recycle packaging and all protective materials.

**Equipment recycling:** Electrical and electronic equipment contains materials that, when incorrectly handled, can be harmful to human health and the environment. Do not dispose of any equipment component in household waste. In accordance with current legislation, place them in duly authorized collection/recycling centres.

*The producer declines every responsibility on any print and/or transcription mistake contained in this instruction manual.*

*Any time and without notice, the manufacturer can change features and data of this document with the proposal of keeping on increase the quality of its products and, therefore, this manual cannot be considered as a contract with respect to third parties.*